

FUEL TANK HONDA CRF450X 15.5L

SERBATOIO HONDA CRF450X 15,5L

COD. 500001268 REV.4

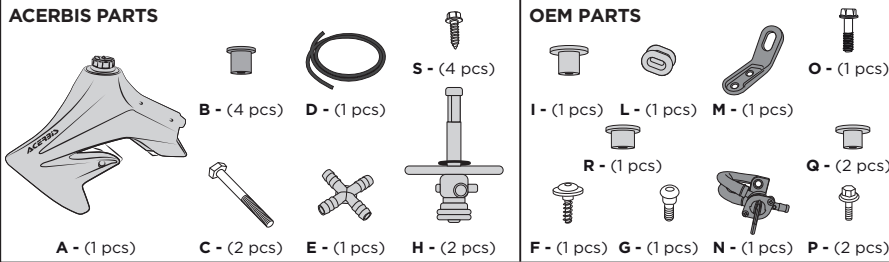

WARNING

Durante il rimontaggio suggeriamo vivamente di utilizzare un grasso anti-grippante su tutte le viti.

Highly suggest to use anti-seize/grease lubricant on all bolt threads going into the tank's metal inserts when reinstalling.

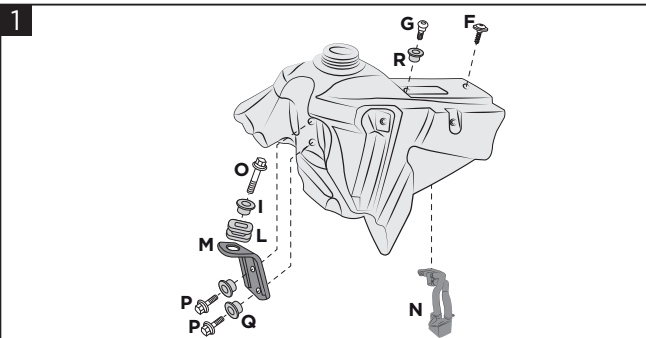

Remove the following parts from the original tank: bracket (M), bushings (Q), screws (P), grommet (L), bushing (I) and screw (O). Remove the screws (F), (G), the bushing (R) and the tap (N).

Rimuovere dal serbatoio originale la staffa (M), le boccole (Q), le viti (P), il gommino (L), la boccola (I) e la vite (O). Svitare le viti (F), (G) e la boccola (R) e rimuovere il rubinetto (N).

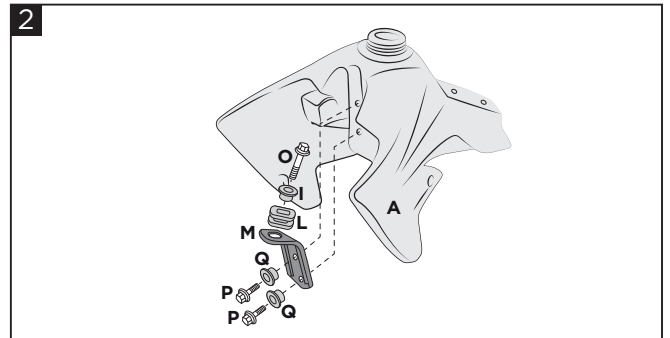

Reassemble bracket (M), bushings (Q), screws (P), grommet (L), bushing (I) and screw (O) on the Acerbis tank (A).

Rimontarle sul serbatoio Acerbis (A) la staffa (M), le boccole (Q), le viti (P), il gommino (L), la boccola (I) e la vite (O).

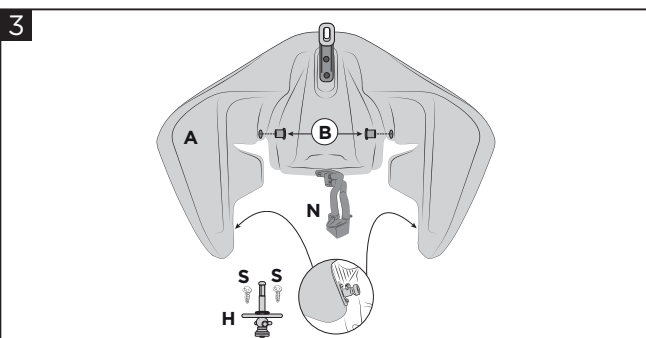

Insert bushings (B) on the Acerbis tank (A). Mount the original tap (N) and the two provided (H) on the center using the screws (S). Check that their O-Rings are still in the right place.

Inserire sul serbatoio Acerbis (A) le boccole (B). Montare centralmente il rubinetto originale (N) ed i due in dotazione (H) tramite le viti (S) facendo attenzione che siano correttamente inseriti i loro O-Rings.

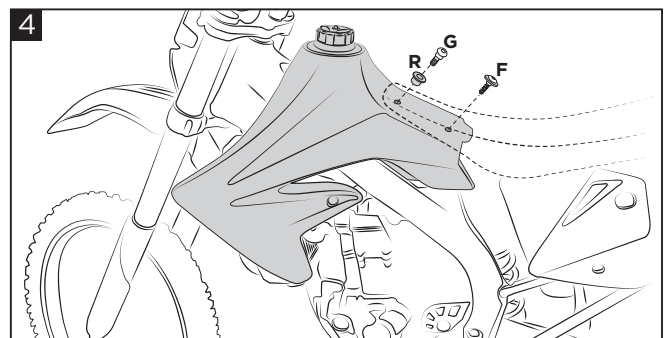

Secure the tank using the original screw (G) and bushing (R) and tighten the screw of the bike seat (F).

Fissare il serbatoio tramite vite e boccola originali (G) ed (R) ed avvitare la vite sella (F).

WARNING!

It is **EXTREMELY IMPORTANT** that the fuel tank is properly installed. To ensure proper installation, it is **STRONGLY RECOMMENDED** that the tank is installed only by a qualified OEM licensed dealership mechanic. Improper installation could result in serious injuries or death.

If self-installed **NOTE THE FOLLOWING**: particular attention must be paid to excessive fuel line length and fuel line proximity to hot engine areas and pipes to prevent fire.

Clean tank interior thoroughly before installation. Install this fuel tank only in a well ventilated area, as gasoline fumes are extremely dangerous. Do not start or operate the vehicle if there are any fuel leaks! Read all instructions first before beginning installation.

EUROPE

ACERBIS ITALIA S.P.A.
VIA SERIO, 37
24021 ALBINO (BG)
ITALY

U.S.A.

ACERBIS U.S.A. INC.
MAIL P.O. BOX 2030
SUN VALLEY, ID 83353
SHIP 110 LINDAY CIRCLE
KETCHUM, ID 83340
U.S.A.

UNITED KINGDOM

ACERBIS U.K LTD
UNIT 2 LUTON ENTERPRISE PARK
SUNDON PARK ROAD
LUTON, BEDFORDSHIRE LU3 3GU
GREAT BRITAIN

ACERBIS

FUEL TANK HONDA CRF450X 15.5L SERBATOIO HONDA CRF450X 15,5L

COD. 500001268 REV.4

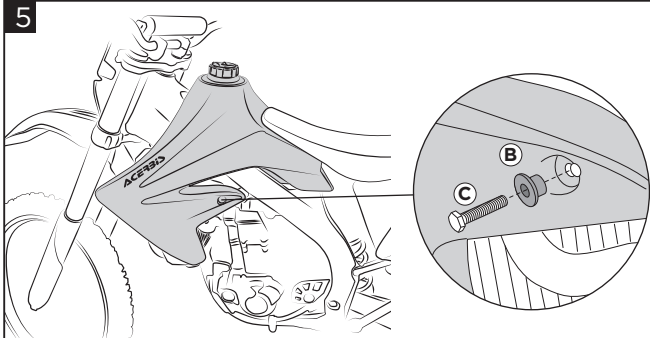

5
Attach the tank on both its sides using bushings (B) and screws (C).

Fissare lateralmente il serbatoio tramite boccola (B) e vite (C) su entrambi i lati.

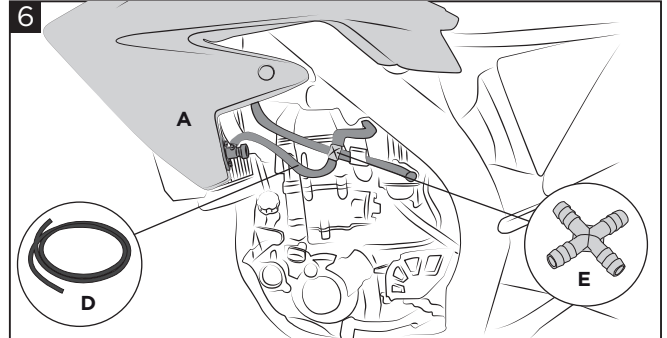

6
Cut the fuel hose to the right length, then attach it to the cross fitting (E) and the two provided taps (H), the original tap (N) and the carburetor.

Tagliare il tubo (D) delle dimensioni corrette, montandolo nel raccordo a croce (E) ai due rubinetti in dotazione (H), al rubinetto originale (N) e al carburatore.

DISCLAIMER

Due to uncontrolled variables in the manufacturing process of rotational molded fuel tanks, the fuel tank may vary in size and shape by up to 7% of the manufacturer's original listed capacity.

LIBERATORIA

A causa di variabili inponderabili nel processo di stampaggio rotazionale dei serbatoi, questi possono differire in forma e dimensioni fino al 7% rispetto alla capacità dichiarata.

FOR COMPETITION USE ONLY - SOLO PER USO MOTOCICLISTICO

WARNING!

It is EXTREMELY IMPORTANT that the fuel tank is properly installed. To ensure proper installation, it is STRONGLY RECOMMENDED that the tank is installed only by a qualified OEM licensed dealership mechanic. Improper installation could result in serious injuries or death.

If self-installed NOTE THE FOLLOWING: particular attention must be paid to excessive fuel line length and fuel line proximity to hot engine areas and pipes to prevent fire.

Clean tank interior thoroughly before installation. Install this fuel tank only in a well ventilated area, as gasoline fumes are extremely dangerous. Do not start or operate the vehicle if there are any fuel leaks! Read all instructions first before beginning installation.

EUROPE

ACERBIS ITALIA S.P.A.
VIA SERIO, 37
24021 ALBINO (BG)
ITALY

U.S.A.

ACERBIS U.S.A. INC.
MAIL P.O. BOX 2030
SUN VALLEY, ID 83353
SHIP 110 LINDAY CIRCLE
KETCHUM, ID 83340
U.S.A.

UNITED KINGDOM

ACERBIS U.K LTD
UNIT 2 LUTON ENTERPRISE PARK
SUNDON PARK ROAD
LUTON, BEDFORDSHIRE LU3 3GU
GREAT BRITAIN