

SUZUKI FUEL TANK DRZ400S/SM 15L

SERBATOIO SUZUKI DR400S/SM 15L

COD. 500009073 REV.1

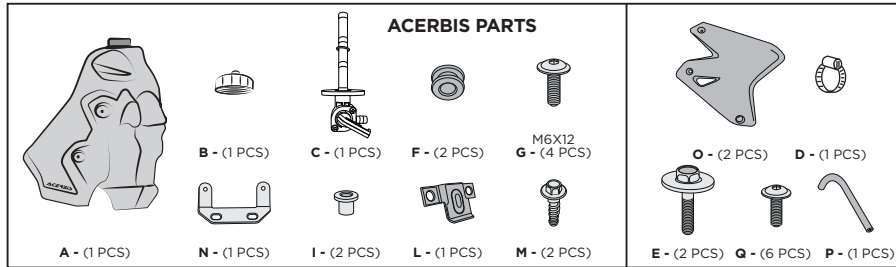

WARNING

Durante il rimontaggio suggeriamo vivamente di utilizzare un grasso anti-grippante su tutte le viti.

Highly suggest to use anti-seize/grease lubricant on all bolt threads going into the tank's metal inserts when reinstalling.

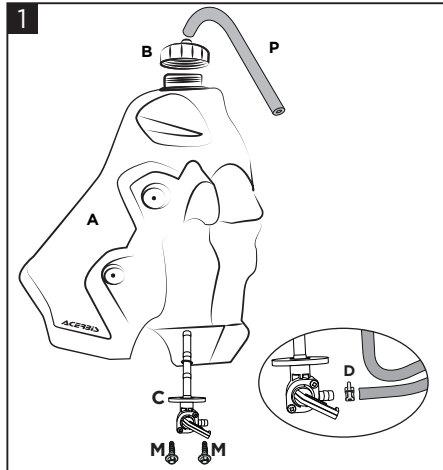

1

Insert the tube (P) original in the cap (B). Assemble the petcocks (C) including O-Ring using the appropriate screws (M). Fit the original clamp (D) on the pipe before connect it to the petcock.

Inserire il tubo (P) originale sul tappo (B). Montare il rubinetto (C) compreso di O-ring utilizzando le apposite viti (M) in dotazione. Montare la fascetta originale (D) sul tubo prima di collegarlo al rubinetto.

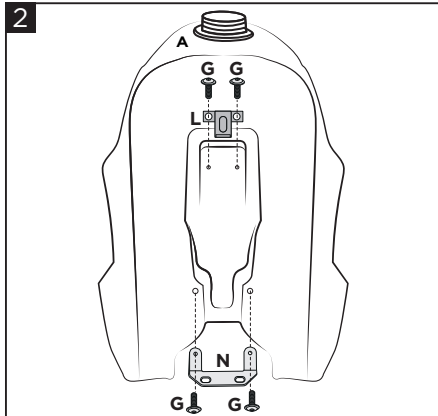

2

Fix the bracket (L) through the screws (G). Fix the bracket (N) using the screws (G) without tightening.

Fissare la staffa (L) tramite le viti (G). Fissare la staffa (N) utilizzando le viti (G) senza stringere.

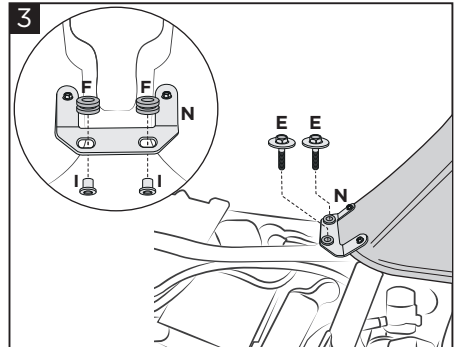

3

Insert the rubbers (F) and the bushings (I) in the bracket (N). Place the tank on the frame, making the bracket rest correctly. Fix the bracket (N) through the original screws (E) and tight the screws (G).

Inserire i gommini (F) e le bocchette (I) nella staffa (N). Posizionare il serbatoio sul telaio facendo poggiare correttamente la staffa. Fissare la staffa (N) tramite le viti originali (E) e stringere le viti (G).

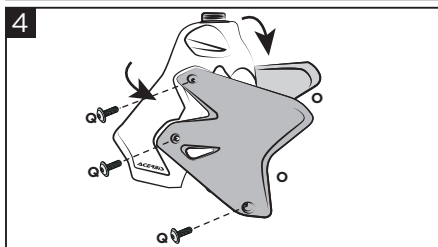

4

Reassemble the side panels (O), using the original screws (Q).

Rimontare i fianchetti (O) utilizzando le viti originali (Q).

DISCLAIMER

Due to uncontrolled variables in the manufacturing process of rotational molded fuel tanks, the fuel tank may vary in size and shape by up to 7% of the manufacturer's original listed capacity.

LIBERATORIA

A causa di variabili inponderabili nel processo di stampaggio rotazionale dei serbatoi, questi possono differire in forma e dimensioni fino al 7% rispetto alla capacità dichiarata.

FOR COMPETITION USE ONLY - SOLO PER USO MOTOCICLISTICO

WARNING!

It is EXTREMELY IMPORTANT that the fuel tank is properly installed. To ensure proper installation, it is STRONGLY RECOMMENDED that the tank is installed only by a qualified OEM licensed dealership mechanic. Improper installation could result in serious injuries or death.

If self-installed NOTE THE FOLLOWING: particular attention must be paid to excessive fuel line length and fuel line proximity to hot engine areas and pipes to prevent fire.

Clean tank interior thoroughly before installation. Install this fuel tank only in a well ventilated area, as gasoline fumes are extremely dangerous. Do not start or operate the vehicle if there are any fuel leaks! Read all instructions first before beginning installation.

Acerbis recommends that installation must be done by a licensed mechanic and that only Acerbis' original parts are used during installation. Acerbis makes no guarantees or representations, express or implied, regarding the fitment of its product for any particular purpose. Acerbis makes no guarantees or representations, express or implied, regarding the extent to which its products protect individuals or property from injury or death or damage.

EUROPE

ACERBIS ITALIA S.P.A.
VIA SERIO, 37
24021 ALBINO (BG)
ITALY

U.S.A.

ACERBIS U.S.A. INC.
MAIL P.O. BOX 2030
SUN VALLEY, ID 83353
SHIP 110 LINDAY CIRCLE
KETCHUM, ID 83340
U.S.A.

UNITED KINGDOM

ACERBIS U.K LTD
UNIT 4 DUNFERMLINE COURT,
KINGSTON, MILTON KEYNES
MK10 0BY
GREAT BRITAIN